

Global Search for Academic Talents Faculty of Construction and Environment (FCE)

The Hong Kong Polytechnic University
March 2018

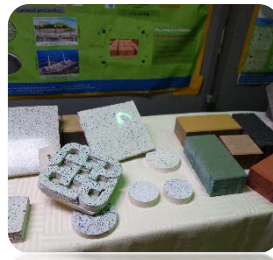

First National Geographic Census in China

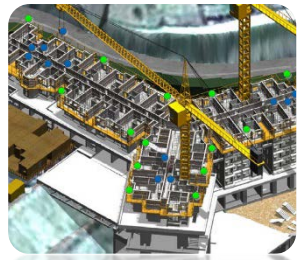



Introduction of FCE

- One of the six faculties in The Hong Kong Polytechnic University
- People in FCE
 - ❖ Academic staff : 133
 - ❖ Non-academic/supporting staff: 107
 - ❖ Research personnel: 283
 - ❖ Research students: 367 (Full-time: 303 / Part-time: 64)
- The widest coverage and the largest concentration of expertise among the universities in Hong Kong in construction and environment-related disciplines
- The construction industry in Hong Kong is undergoing an explosion of growth and issues of natural environment and sustainable development remain a top priority in the coming years in Hong Kong
- FCE offers well-known academic programmes at various levels, including Ug, MSc and PhD degrees, which prepare students for professional careers and leadership positions in a wide range of disciplines



- FCE is committed to research excellence in construction and environment, and engaging in world-class research in strategic areas with national and international partners

- International Rankings of FCE
 - ❖ **Ranked 19th** in the world by 2018 Quacquarelli Symonds (QS) University Rankings by Subject in **Architecture / Built Environment**

 - ❖ **Ranked 10th** in the world by 2018 Quacquarelli Symonds (QS) University Rankings by Subject in **Civil and Structural Engineering**

 - ❖ **Ranked 17th** in the world in **Engineering Research disciplines**, according to the Best Global Universities Rankings 2018 by the U.S. News and World Report

 - ❖ **Ranked 8th** in the world by ShanghaiRanking's Global Ranking of Academic Subjects 2017 - the Center for World-Class Universities of Shanghai Jiao Tong University in **Transportation Science & Technology**

- There are four departments under FCE, namely:
 - ❖ Department of Building and Real Estate (BRE)
 - ❖ Department of Building Services Engineering (BSE)
 - ❖ Department of Civil and Environmental Engineering (CEE)
 - ❖ Department of Land Surveying and Geo-Informatics (LSGI)



Summary of Academic Vacancies 2018/19

Department	Position	Discipline	Vacancies
BRE	Associate/ Assistant Professor	Construction & Real Estate Economics	2
	Associate/ Assistant Professor	Construction & Real Estate Management	1
BSE	Assistant Professor	Building Environment/ Building Safety and Resilience	1
CEE	Professor/ Associate Professor	Hydraulic Engineering	1
	Assistant Professor	Geotechnical Engineering	1
LSGI	Assistant Professor	Land Surveying/ Geo-information Technology/ Utility Surveying	1

* It is expected that the above vacancies can be filled up before July 2019.



Department of Building and Real Estate (BRE)

- One of the very first three departments of the University established in 1937
- Strong research activities
- Attractive teaching programmes with professional accreditations
- Large number of remarkable alumni
- Strong links with the industry
- Intellectually-challenging environment
- **Ranked 19th** in the subject **Architecture / Built Environment** by QS World University Rankings by Subject 2018
- **Ranked 8th** in the **Architecture** by the University Ranking by Academic Performance (URAP) 2016-17
- **Ranked 2nd** in the **Built Environment and Design** by the University Ranking by Academic Performance (URAP) 2014-15.
- **Tops** the world in the publication of articles related to the field of **construction and building technology** (Canas-Guerrero et al, 2014)



Department of Building Services Engineering (BSE)

- Offering a world class academic research and teaching **BSE programme** with the theme energy-efficient building environment design for occupant comfort, health, productivity and safety; Our graduates in BSE including bachelor, master and PhD holders are in high demand in professional and academic communities, both locally and internationally
- Our colleagues consist of world-wide **recognized academic leaders** and a team of dedicated supporting staff; Recognitions include editor-in-chief and associate editor positions of top journals, and fellowship from leading international societies, such as ASHRAE, ISIAQ, and IBPSA
- Having a proud record in winning **research grants**, in particular, winning a large collaborative research grant recently
- **Research outputs** include not only academic publications in top journals, but also award-winning patents and technology transfer consultancy services
- **Highly ranked** by a number of university ranking organizations such as the U.S. News and World Report, and the Quacquarelli Symonds (QS) University Rankings (e.g. **Ranked 19th** in the World by 2018 QS World University Rankings by Subject in **Architecture/Built Environment**)



Department of Civil and Environmental Engineering (CEE)

- CEE offers **academic programmes at various levels**, including MSc and PhD degrees, in the disciplines of Construction and Transportation Engineering, Environmental Engineering Science, Geotechnical Engineering, Hydraulic Engineering, and Structural Engineering.
- The Department enjoys a **strong reputation** in application-oriented research and has well established connections with industry partners and government agencies in Hong Kong.
- The Department currently has about 40 faculty members and 36 technical and administrative personnel, and is committed to the **international standards of excellence in teaching and research**.
- Discipline rankings:

QS Ranking

In the recent 2018 QS Subject Rankings, PolyU was ranked **10th in the Civil and Structural Engineering discipline** and has been **ranked 1st** in an objective research performance indicator (**H-index**).

NTU Ranking

In a recent NTU ranking compiled by the National Taiwan University, the Civil Engineering Discipline at PolyU has been ranked **6th in the world** for **2017** in terms of **scientific papers outputs and citations**.

Shanghai Ranking

In a recent ShanghaiRanking's Global Ranking of Academic Subjects 2017 conducted by the Center for World-Class Universities of Shanghai Jiao Tong University, PolyU has been ranked **8th in the world in Transportation Science & Technology**.



Department of Land Surveying and Geo-Informatics (LSGI)

- An internationally reputable Centre of Excellence in both education and research in land surveying and geo-informatics
- Number of **SCI paper citations** per academic staff is **ranked No. 1** and **Number of SCI paper publication** per academic staff is **ranked No. 2** in the discipline of **geomatics** worldwide
- Offer **broad spectrum of programmes** (PhD, MPhil/MSc, BSc) in Geomatics in three specialized streams : Land Surveying, Geo-Information Technology, and Utility Surveying and Management
- Highly diversified **research programmes** including GIS, GNSS, Ubiquitous Positioning, Remote Sensing, Geodynamics, Environmental Monitoring, Geo-hazards Studies, ITS, Digital City Modeling, Sustainable Urbanization, Utility System Management, Location Based Services (LBS), Geographical Social Science, and Land Information System and Management
- A **strong team** of 22 academic staff and 13 supporting staff
- A number of **well-equipped** research and teaching **laboratories**



You are welcome to contact us:

- Department of Building and Real Estate (BRE)
Prof. Albert Chan, Head of BRE, e-mail: albert.chan@polyu.edu.hk
- Department of Building Services Engineering (BSE)
Professor Asif Sohail Usmani, Head of BSE, e-mail:
asif.usmani@polyu.edu.hk
- Department of Civil and Environmental Engineering (CEE)
Prof. William H.K. Lam, Head of CEE, e-mail: william.lam@polyu.edu.hk
- Department of Land Surveying and Geo-Informatics (LSGI)
Prof. John Shi, Head of LSGI, e-mail: john.wz.shi@polyu.edu.hk
- FCE Web-site: <http://www.polyu.edu.hk/fce/academic-vacancies/>
- Advertisements posted can be viewed at :
http://www.polyu.edu.hk/hro/job/en/external_adv/academic.php